

CYLINDER LINER AND CAPACITY CONTROL

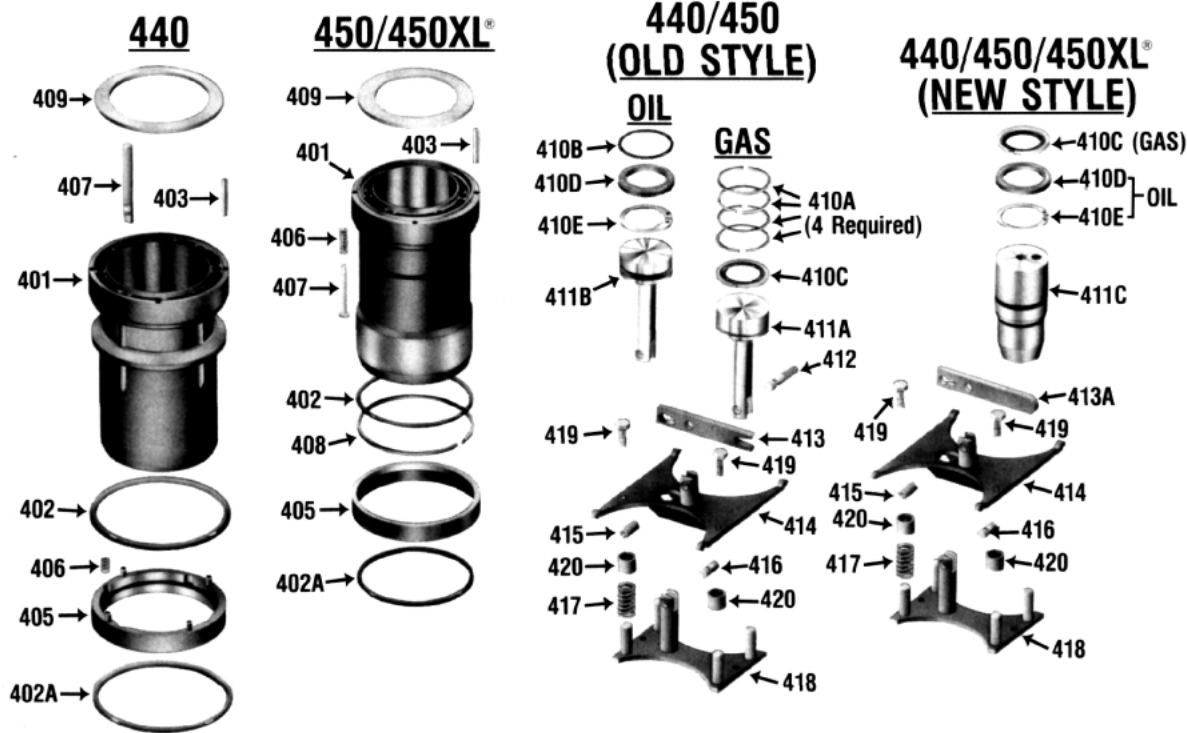

Reference Number	440	450	450XL	Description
401	32687A	34510A	34510A	Liner, Cyclinder (Single-Stage)
401	33179A	34710A	34710A	Liner, Cyclinder (Integral Two-Stage)
402	2176BH	2176BH	2176BH	Seal, "O" Ring, Upper
402A	2176BL	2176BL	2176BL	Seal, "O" Ring, Lower (Integral Two-Stage)
403	1193Q	1193Q	1193Q	Pin, 1/8" X 1-1/2" Roll
405	A33351A	35071A	35071A	Ring, Lift
406	33352A	35069A	35069A	Spring, Lift
407	33350A	35070A	35070A	Pin, Lift
408	-	1971A	1971A	Retainer, Lift Ring
409	31909A	31909A	31909A	Plate, Suction Valve
410A(a)	31989L	31989L	-	Ring, Piston, Gas (Old Style)
410B(a)	2045A	2045A	-	O-Ring, Oil (Old Style)
410C(b)	2557A	2557A	2557A	Ring, Gas
410D(b)	2639A	2639A	2639A	Ring, Oil
410E	2638A	2638A	2638A	Retainer, Snap Ring, Oil
411A, 410C ^(c)	KT034	KT034	-	Piston, Gas (Old Style)
411B,				
410D/E ^(c)	KT364	KT364	-	Piston, Oil (Old Style)
411C(d)	35315A	35315A	35315A	Piston, Gas or Oil
412	33250C	33250C	-	Pin, Long Pivot
413(e)	33338A	33338A	-	Arm, Yoke Lifting (Old Style)
413A(e)	41725A	41725A	41725A	Arm, Yoke Lifting (New Style)

Reference Number	440	450	450XL	Description
414	A33335A	A33335A	A33335A	Yoke Assembly, Std. Unloading
414	A33575A	A33575A	A33575A	Yoke Assembly, Single Cyl. Unloading
415	1193X	1193X	1193X	Pin, 3/8" X 11/16" Roll
416	33250B	33250B	33250B	Pin, Short Pivot
417	33686A	33686A	33686A	Spring, Unloader Yoke
418	A33347A	A33347A	A33347A	Yoke Guide, Std. Unloading
418	A33576A	A33576A	A33576A	Yoke Guide, Single Cyl. Unloading
419	1352D	1352D	1352D	Screw, 3/8" X 1" Hex Head Lock, Single Cyl. Unloading
420	33618A	33618A	33618A	Spacer, Sleeve, Single Cyl. Unloading

(a) 410A and 410B- Sold for replacement use only; will not fit present pistons.

(b) 410C and 410D- Not interchangeable with old (410A and 410B).

(c) 411A and 411B- Present pistons cannot be used with old rings kit. KT034 contains 410C; KT364 contains 410D/E.

(d) 411C- New piston not interchangeable with old (requires different frame). New piston has two grooves- top for gas and bottom for oil.

(e) 413 and 413A- Yoke lifting arms not interchangeable.